

A blurred background image of an architectural workspace. It features a desk with various items: a computer monitor displaying architectural drawings, a keyboard, a calculator, several pens and markers, and several sheets of paper with hand-drawn architectural sketches and plans. The overall tone is professional and creative.

# 33 CENTRE AVENUE

## RESIDENTIAL DEVELOPMENT

### TORONTO, ONTARIO

APRIL 1, 2021

**PETROFF PARTNERSHIP ARCHITECTS**  
260 Town Centre Boulevard, Third Floor. Markham, Ontario L3R-8H8  
Main 905 470 7000  
[www.petroff.com](http://www.petroff.com)

# PETROFF

PETROFF PARTNERSHIP ARCHITECTS



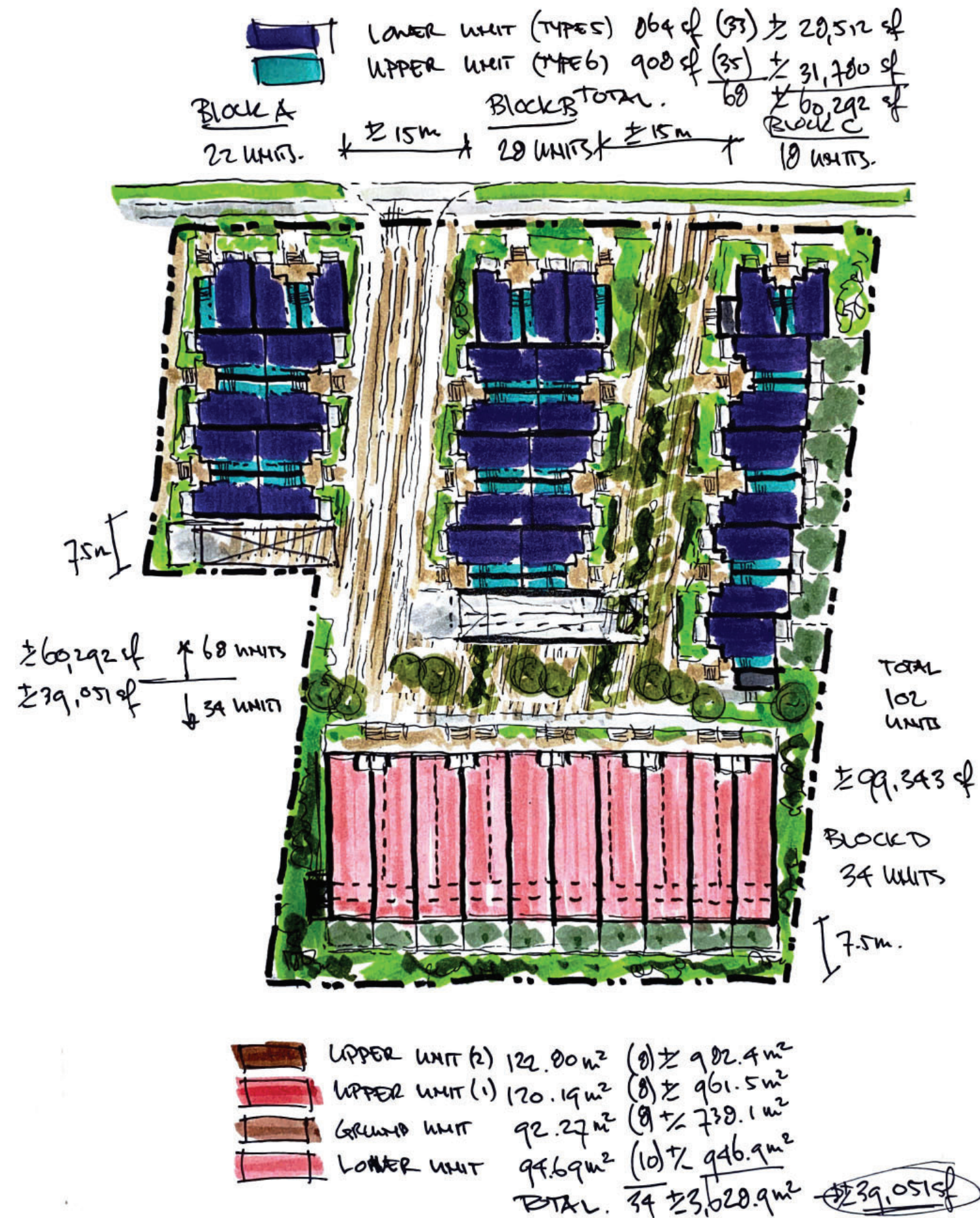

## BLOCK A, B AND C TYPICAL UNITS:



## BLOCK D TYPICAL UNITS:



UNITS: +/- 102

GFA: +/- 99,343SF

19125 - 33 CENTRE AVENUE,  
TORONTO, ON  
APRIL 1, 2021

**PETROFF**

PETROFF PARTNERSHIP ARCHITECTS



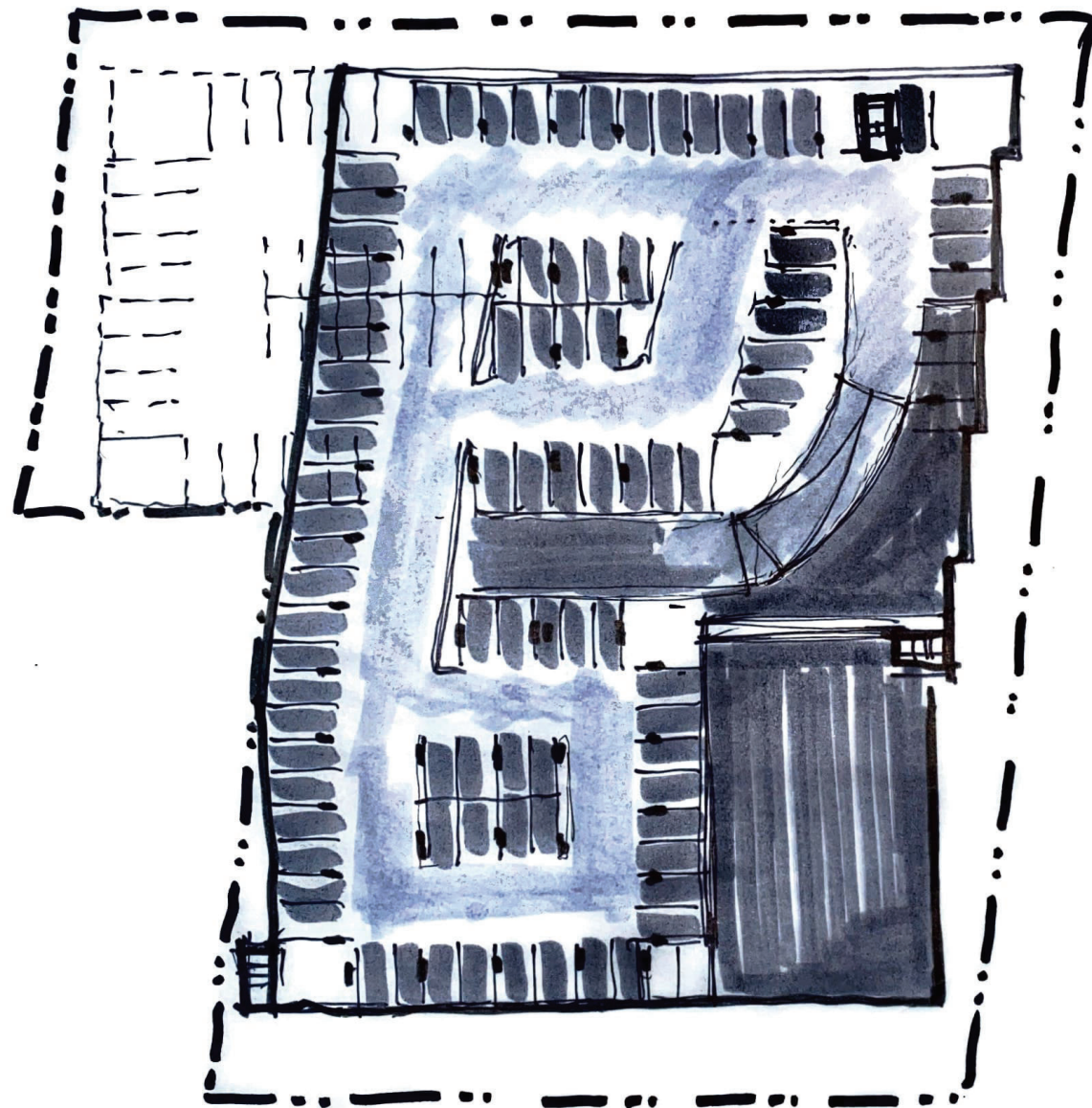

+ 90 PARKING SPACES.  
(CAN BE EXTENDED TO PROVIDE + 120 PARKING SPACES.)

19125 - 33 CENTRE AVENUE,  
TORONTO, ON  
APRIL 1, 2021

**PETROFF**  
PETROFF PARTNERSHIP ARCHITECTS 3